



Z-6000 | Z-7000

OWNER'S MANUAL

PERFORMANCE AIR PURIFIERS

TruSens™

ENGLISH	4
GERMAN	20
FRENCH	36
ITALIAN	52
SPANISH	68
PORTUGUESE	84
DUTCH	100
DANISH	116
NORWEGIAN	132
SWEDISH	148
FINNISH	164
ESTONIAN	180
LATVIAN	196
LITHUANIAN	212
POLISH	228
CZECH	244
SLOVAK	260
HUNGARIAN	276
ROMANIAN	292
GREEK	308
TURKISH	324



WELCOME TO CLEANER AIR

CONTENTS

SAFETY INFORMATION	6
FEATURE HIGHLIGHTS	8
PRODUCT OVERVIEW	9
GETTING STARTED	10
CONTROL PANEL	12
AIR QUALITY DISPLAY	13
SPECIFICATIONS	14
CARE & MAINTENANCE	15
Replacing HEPA/Carbon Filters	15
Washing the Prefilters	16
FAQ & TROUBLESHOOTING	17
GUARANTEE & SUPPORT	19

SAFETY INFORMATION

PLEASE READ AND SAVE THESE INSTRUCTIONS

Unplug or disconnect the appliance from the power supply before replacing filters or when the appliance is not in use.



WARNING: To reduce the risk of fire or electric shock, do not use this fan with any solid-state speed control device.

Do not operate any purifier with a damaged cord or plug, or if the wall socket is loose. If the supply cord is damaged, it must be replaced by the manufacturer, its service agent or similarly qualified persons in order to avoid a hazard.

Do not run cord under carpeting, throw rugs, runners, or similar coverings.

Do not run cord under furniture or appliances. Arrange cord away from traffic area and where it will not be tripped over.



WARNING: Skin or eye damage may result from directly viewing the light produced by the UV-C emitter in this apparatus. Unintended use of the appliance or damage to the housing may result in the escape of dangerous UV-C radiation. UV-C radiation may, even in small doses, cause harm to the eyes and skin.

- Remove all packaging, including the filter bag, before use.
- Appliances that are obviously damaged must not be operated.
- The A-weighted emission sound pressure level is below 70 dB(A).
- This appliance is designed to be used in commercial areas.
- This appliance must only be connected to a wall socket outlet matching the supply plug type and rating stated on the rating plate.
- Locate air purifier near the outlet wall socket and do not use extension cords.
- This appliance can be used by children aged from 8 years and above and persons with reduced physical, sensory or mental capabilities or lack of experience and knowledge if they have been given supervision or instruction concerning use of the appliance in a safe way and understand the hazards involved.
- Children shall not play with, clean, or try to maintain the appliance.
- Do not attempt to service or repair this product yourself.
- Only use the purifier and SensorPod™ with the power cable provided.
- Only clean this machine with a damp cloth, do not use solvents or bleach.
- Ensure appliance is always placed on firm level surface before operation.
- Do not block or obstruct the air intake or outlet vents.
- Do not insert fingers or other items into the air intake or outlet vents.
- When the air purifier is in standby mode the SensorPod™ is still transmitting a signal/data.

Operating Frequency

Wireless: 2402-2480 MHz

Maximum Transmit Power (EIRP)

Wireless: 7.1 dBm

Antenna Gain

Wireless: 2 dBi

Hereby, Leitz ACCO Brands GmbH & Co KG declares that the radio equipment types, Leitz TruSens Air Purifier Z-6000/Z-7000 are in compliance with Directive 2014/53/EU and UK Radio Equipment regulations.

The full text of the EU/UK declaration of conformity is available at the following internet address:
<https://declarations.accobrand.com/>

A minimum separation distance of 0.2m must be maintained between the user's body and the device, to comply with RF exposure requirements.

**Waste Electrical and Electronic Equipment (WEEE)**

At the end of its useful life, your product is considered to be WEEE. As such, it is important to note that: WEEE is not to be disposed of as unsorted municipal waste. It is to be collected separately such that it can be disassembled so its components and materials can be recycled, re-used, and recovered (burned for energy content in the production of electricity).

Public collection points have been set up by municipalities for the collection of WEEE, free of charge to you. Please return your WEEE to the collection facility nearest your home or office.

If you have difficulty locating a collection facility, the retailer that sold you the product should accept your WEEE. If you are no longer in contact with your retailer, please contact Leitz for assistance with this matter. Recycling of WEEE is geared toward protecting the environment, protecting human health, preserving raw materials, improving sustainable development, and ensuring a better supply of commodities in the European Union and United Kingdom. This will be achieved by retrieving valuable secondary raw materials and reducing the disposal of waste. You can contribute to the success of these goals by returning your WEEE to a collection facility.

Your product is marked with the WEEE symbol (wheelie bin with an X through it). This symbol is to inform you that the WEEE is not to be disposed of as unsorted municipal waste.

FEATURE HIGHLIGHTS

TRU-BEAM™

TRU-BEAM™ UV-C

Proprietary TRU-BEAM UV-C system. No replacements required.



Dual-sided Filtration

Combination filter featuring HEPA to capture pollutants and Activated Carbon to capture odours and VOCs on both sides.



SensorPod™

Remote air quality monitor that ensures cleaner air, right where you need it.



Informs and Adapts

Colour-coded illumination provides additional information by communicating air quality in real-time.

PRODUCT OVERVIEW

Air Purifier

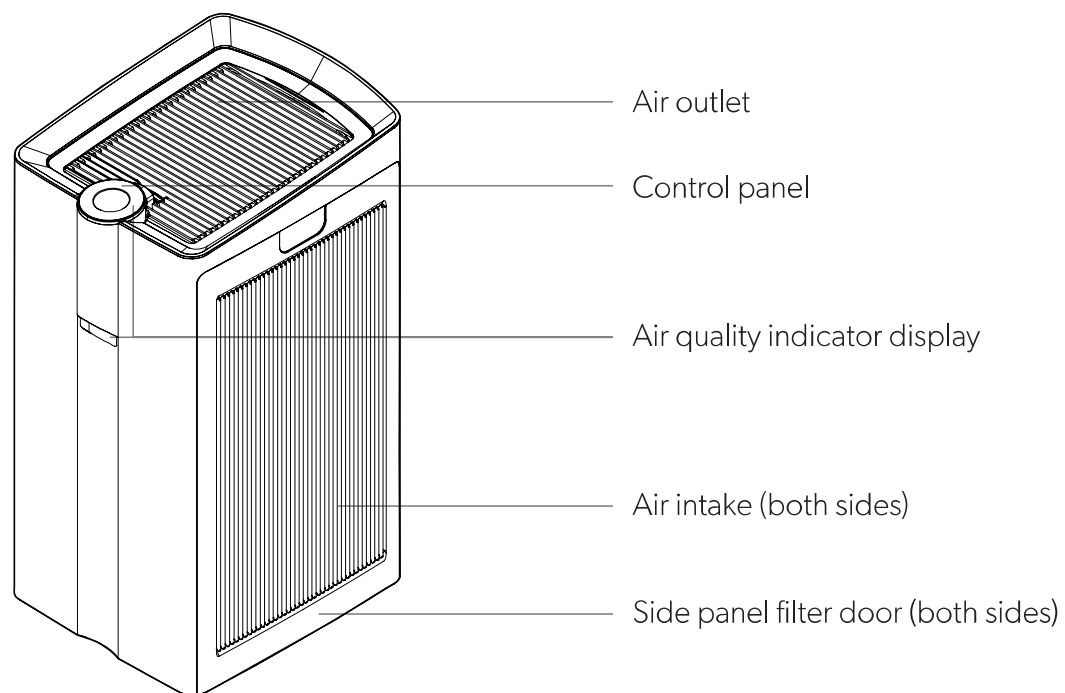

SensorPod™

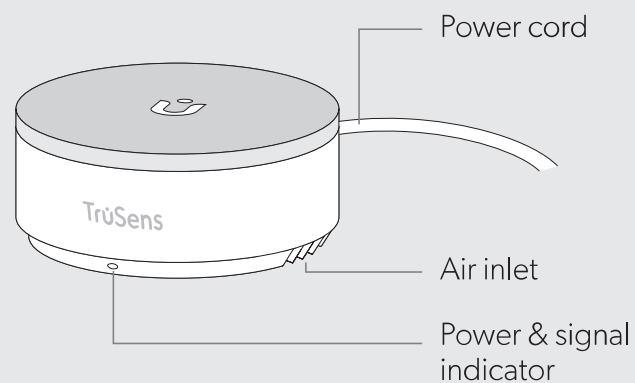

Filters

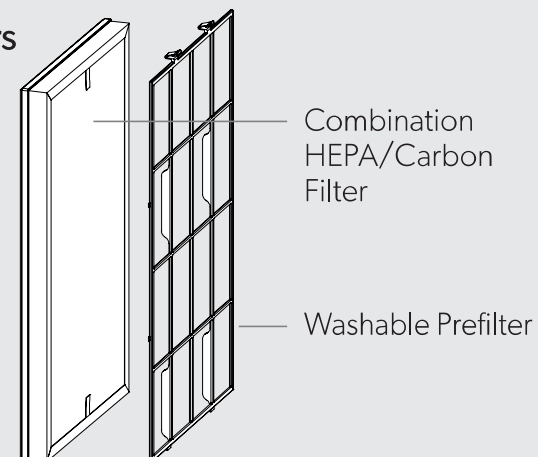

GETTING STARTED



Install the filter (combination HEPA/Carbon)

Remove side panel door (a), prefilter (b) then bagged HEPA/Carbon filter. Remove plastic bag from filter (c) and install inside the purifier with HEPA layer (white) on the inside, and the Carbon layer (black) on the outside. Replace the prefilter and side panel door.

NOTE: Perform steps on both left and right sides.

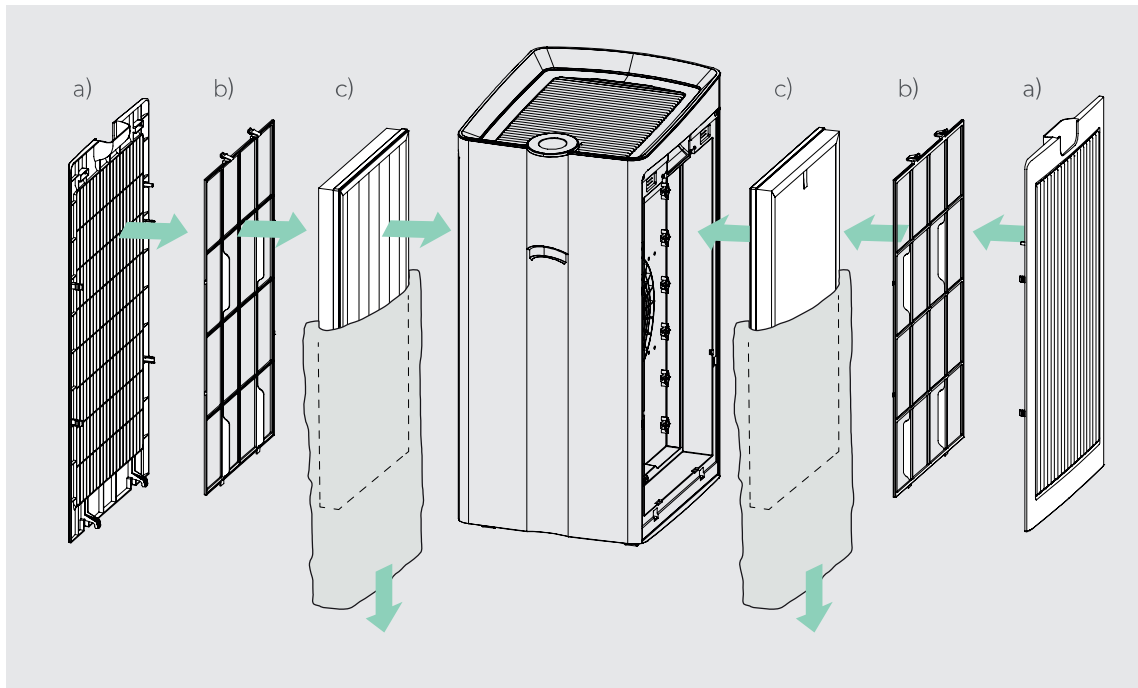

Set up

Plug-in your SensorPod™, and place upright on a tabletop or counter across the room, within line of sight of the purifier.

Plug-in your air purifier unit and power on. Place the purifier on a flat surface, free from obstructions.

Signal strength may vary by location. In the rare occasion that it doesn't work – see page 18.

Start living with cleaner air!

The purifier will automatically adjust fan speeds based on the air quality readings from SensorPod, and will deliver purified air in the room.

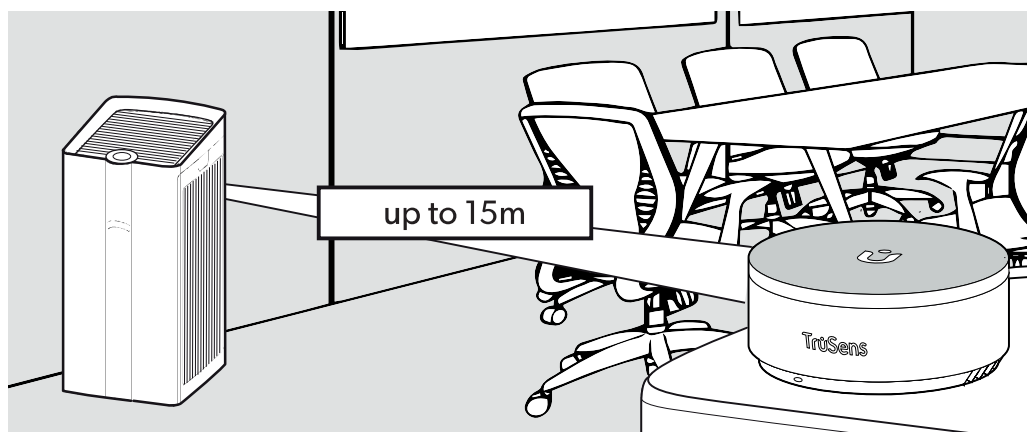

CONTROL PANEL



SensorPod™ Signal Indicator



Power Button



Fan Speed Settings

Select fan speed or AUTO mode. In AUTO mode, purifier automatically adjusts fan speed based on air quality readings from SensorPod.

(AUTO mode only available when purifier is paired with SensorPod and receiving signal)



Dimmer Mode

Display illumination turns off without sacrificing the effectiveness of the purifier. Simply press the button again to bring back all display features.

Filter Reset

Filter Indicator Reset

HEPA and Carbon indicators glow red when it is time to replace the filters. Simply hold Filter Reset button for 3 seconds to reset the indicators. If replacing the filter before HEPA and Carbon indicators turn red, hold Filter Reset button for 10 seconds to reset the indicators.

(See pages 16-18 for replacement instructions. Follow above Reset button instructions after replacing filter.)



UV Mode

UV-C within the purifier's filter chamber are on when the  symbol is on.



Timer Mode

Purifier will automatically turn off after 2, 4, 8, or 12 hours. To cancel this countdown, simply press button until no timer setting is displayed.

AIR QUALITY DISPLAY

Real-time Feedback

The enhanced SensorPod™ evaluates the condition of your air by measuring both particulate matter (PM1.0, PM2.5, PM10) and volatile organic compounds (VOCs). It calculates the overall air quality using a proprietary algorithm that is reactive to genuine increases in pollutants without overreacting.

The illuminated, colour-coded display communicates good, moderate or poor air quality and a numeric value provides a greater level of detail.

In AUTO mode, the purifier automatically adjusts the fan speed in response to these air quality readings.

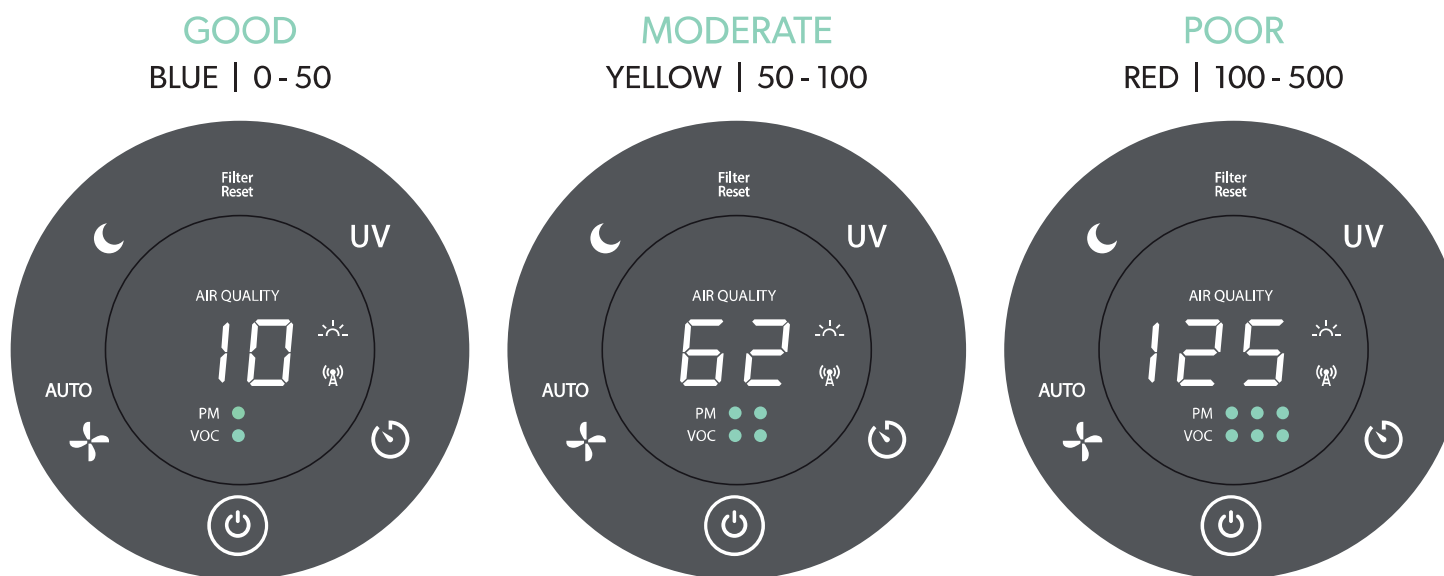

SPECIFICATIONS

	Z-6000 with H13 HEPA*	Z-6000 with E12 EPA*	Z-7000 with H13 HEPA*	Z-7000 with E12 EPA*
Air Inlet	Dual-sided			
Air Outlet	Top			
Sensor	SensorPod™, works up to 15m from purifier			
Fan Speed Settings	Whisper, 1, 2, 3, Turbo, AUTO			
Purification Levels	Washable Prefilter, Carbon, E12 EPA or H13 HEPA, TRU-BEAM™ UV-C			
Timer Settings	2, 4, 8, 12 hr			
Filter Change Indicators	HEPA/Carbon			
Motor Type	DC Motor			
Power Requirements	100-240V AC / 50-60 HZ			
Dimensions	374 x 468 x 693 mm		374 x 468 x 806 mm	
Room Size @ 2 air changes per hour (ACH)	100 m²	155 m²	130 m²	190 m²
Room Size @ 4.84 air changes per hour (ACH)	50 m²	78 m²	65 m²	95 m²
Noise	20 - 46 dB(A)	30 - 53 dB(A)	20 - 47 dB(A)	31 - 54 dB(A)
Weight (with filters installed)	17,3 kg	19,1 kg	18,7 kg	20,5 kg
Power Consumption	54 W	90 W	61 W	100 W
Warranty	2 years			

Replacement Filters (2-pack) - replace every 12 months

Combination EPA with Carbon filter* or Combination HEPA with Carbon filter*	2415162	2415164	2415163	2415165
---	---------	---------	---------	---------

*The filters used in Leitz TruSens Z-6000 / Z-7000 have been tested and graded according to EN 1822-1:2019 & EN ISO 29463-5:2018

CARE & MAINTENANCE



WARNING: Always power off the purifier by pressing the Power Button and unplugging the power cord.

To access the filter chamber, gently remove both side panel filter doors (Fig. A).

REPLACING HEPA/CARBON FILTERS

The HEPA and Carbon indicators will glow red when it is time to change the combination filter.

1. Gently remove the washable prefilters from both sides (Fig. B).
Refer to page 16 for cleaning instructions.
2. Remove the current combination HEPA/Carbon filters from both sides (Fig. C).
3. Gently install the replacement combination HEPA/Carbon filters with the HEPA layer (white) on the inside, and the Carbon layer (black) on the outside (page 10).
4. Replace the prefilters and side panel filter doors on both sides (page 10).
5. Plug-in and power on your purifier, and hold the Reset button until the red filter indicators turns off.

Refer to page 14 for HEPA/Carbon filter replacement part number.

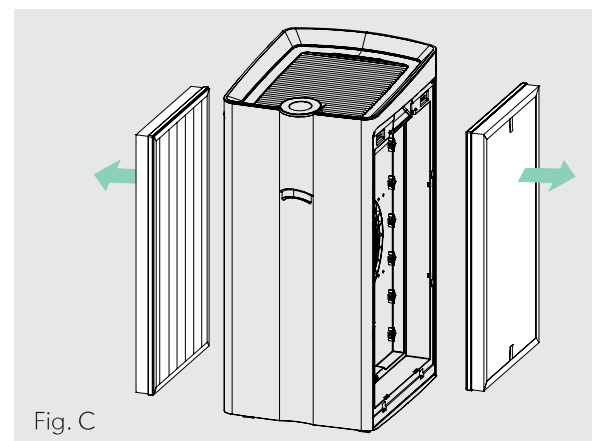
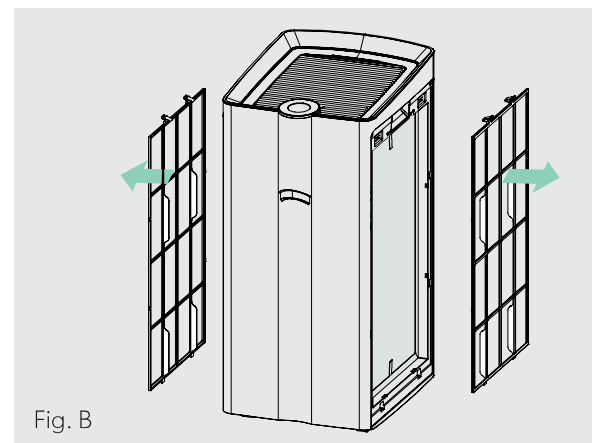
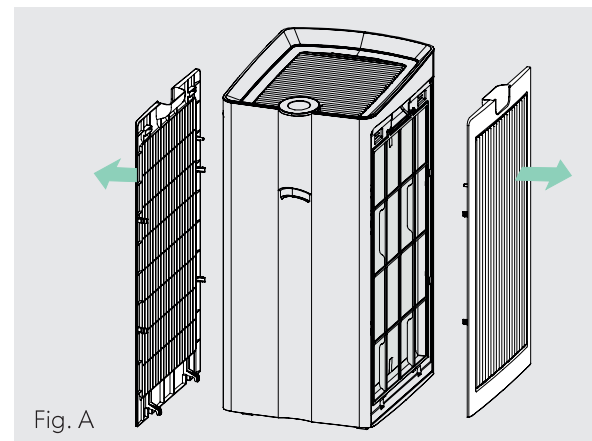

WASHING THE PREFILTERS

We recommend that you visually inspect the prefilters every month, and clean as needed. Wipe clean with a damp cloth or gently vacuum the prefilters every time you change the combination HEPA/Carbon filters.

1. Gently remove both side panel filter doors.
2. Gently remove the prefilters (Fig. D).
3. Gently clean with a dampened cloth or vacuum – allow prefilters to air dry before re-installing (where necessary).
4. Replace the prefilters (Fig. E) and both side panel filter doors.

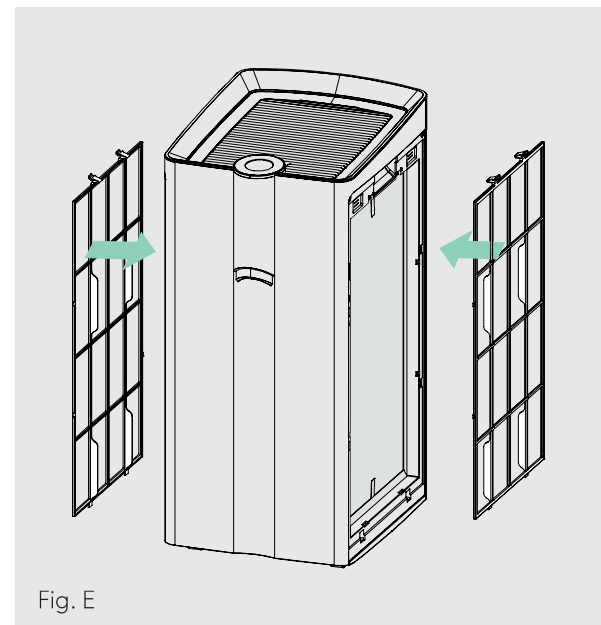
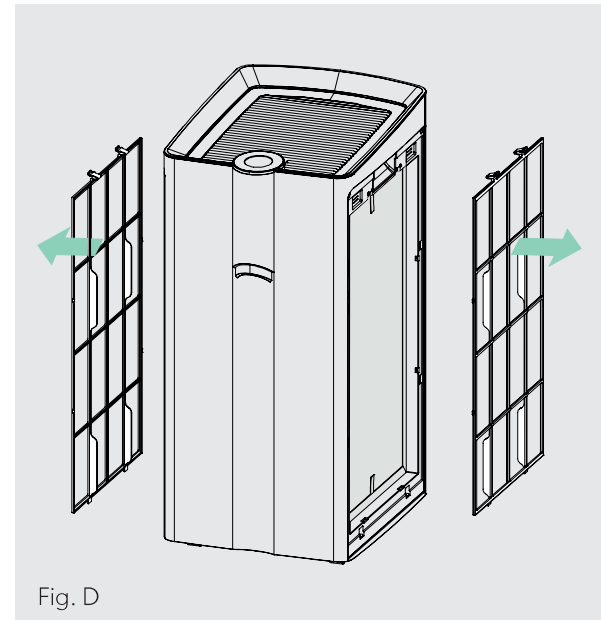

FAQ & TROUBLESHOOTING

<p>Where do I place the SensorPod™?</p>	<p>Anywhere you want to measure the air quality within the room. For optimal results, place the SensorPod™ up to 15m away from the air purifier on a counter or table, within line of sight of the purifier. In Auto Mode, the purifier will work to distribute clean air until the SensorPod reads an acceptable level of air quality.</p>
<p>How often do I need to change the filters?</p>	<p>That's easy! The purifier's replacement indicators will notify you when it is time to replace the combination HEPA/Carbon filters. Plan on replacing the filters every 12 months.</p>
<p>How often do I need to wash the prefilters?</p>	<p>The prefilter captures larger particles and preserves the efficiency of the other filters, so we recommend that you visually inspect the prefilters every month and wash or vacuum as needed.</p>
<p>Purifier won't turn on.</p>	<p>Check that the power cord is connected securely to both the wall outlet and the purifier. Check if there is a power outage in the outlet by trying a nearby light or device, or by trying a working device in the same outlet.</p> <p>Check that the filters and filter covers are fitted properly into filter chamber.</p> <p>Please contact us if you're still having a problem! (page 19)</p>

FAQ & TROUBLESHOOTING

<p>Purifier won't go into Auto Mode.</p> <p>OR</p> <p>Air quality indicators are off.</p> <p>OR</p> <p>Purifier's sensor signal indicator is blinking.</p>	<p>First, check that the SensorPod is plugged-in and that its light is solid.</p> <p>Next, check that the SensorPod is within range of the purifier (up to 15m).</p> <p>If both are true and the connection is still failing, see below instructions on repairing the SensorPod's connection.</p>
<p>I've lost my SensorPod™!</p>	<p>Don't worry! Please contact our customer support team and you can order a replacement SensorPod. Follow the easy pairing instructions below to pair your replacement SensorPod with your existing air purifier!</p>

Pairing SensorPod™ and Purifier

The SensorPod communicates with the purifier using radio frequency signals, and will be paired on the production line and ready for use when you open the box. In the rare event that the signal is interrupted, the purifier's sensor indicator light (📶) will blink. You can repair the connection in just a few easy steps.

1. Unplug the SensorPod.
2. HOLD the Power Button on the purifier for 3 seconds, when you should hear two chimes.
3. Plug-in the SensorPod and press and HOLD the pairing button underneath the SensorPod for 5-7 seconds (Fig. F).

4. The connection is established when the purifier's sensor indicator light is lit with no blinking, and the air quality indicators turn on.

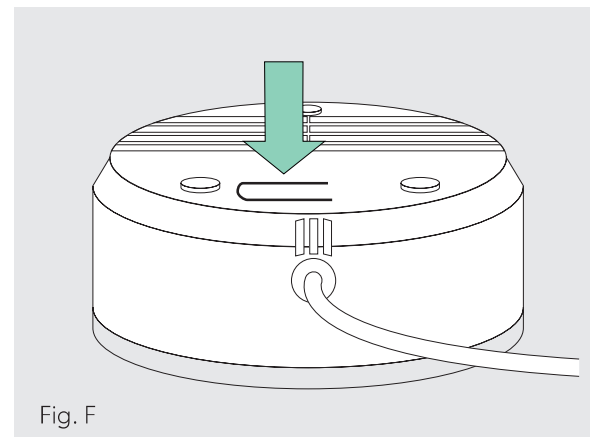

Fig. F

GUARANTEE

Operation of this machine is guaranteed for two years from date of purchase, subject to normal use. Within the guarantee period, ACCO will at its own discretion either repair or replace the defective machine free of charge. Defects due to misuse or use for inappropriate purposes are not covered under the guarantee. Proof of date of purchase will be required. Repairs or alterations made by persons not authorised by ACCO will invalidate the guarantee. It is our aim to ensure that our products perform to the specifications stated. This guarantee does not affect the legal rights which consumers have under applicable national legislation governing the sale of goods.

SUPPORT

Thank you for welcoming TruSens™ into your home. Our customers are at the heart of what we do, and we strive to design products that fit your lifestyle. If you have any questions or feedback, please reach out!

Visit our website at www.leitz.com/trusens

Email us at service.uk@acco.com

Call us at **0800 279 5102**

Ireland: **(01) 6038010**

M-Th **09:00 - 16:30**

F **09:00-16:00**

To register and activate your warranty go to www.leitz.com/register